

**IMPORTANT NOTE:**  
 THIS DRAWING IS THE PROPERTY OF THE DRAWING OFFICE AND IS TO BE USED ONLY FOR THE PROJECT AND SITE SPECIFICALLY MENTIONED THEREIN. NO PART OF THIS DRAWING IS TO BE REPRODUCED OR COPIED IN ANY MANNER WITHOUT THE WRITTEN PERMISSION OF THE DRAWING OFFICE.  
 THE DRAWING IS NOT TO BE USED FOR ANY OTHER PROJECT WITHOUT THE WRITTEN PERMISSION OF THE DRAWING OFFICE.  
 THE DRAWING IS NOT TO BE USED AS A BASIS FOR LIABILITY.  
 THE DRAWING IS NOT TO BE USED FOR ANY OTHER PROJECT WITHOUT THE WRITTEN PERMISSION OF THE DRAWING OFFICE.  
 THE DRAWING IS NOT TO BE USED AS A BASIS FOR LIABILITY.  
 THE DRAWING IS NOT TO BE USED FOR ANY OTHER PROJECT WITHOUT THE WRITTEN PERMISSION OF THE DRAWING OFFICE.  
 THE DRAWING IS NOT TO BE USED AS A BASIS FOR LIABILITY.

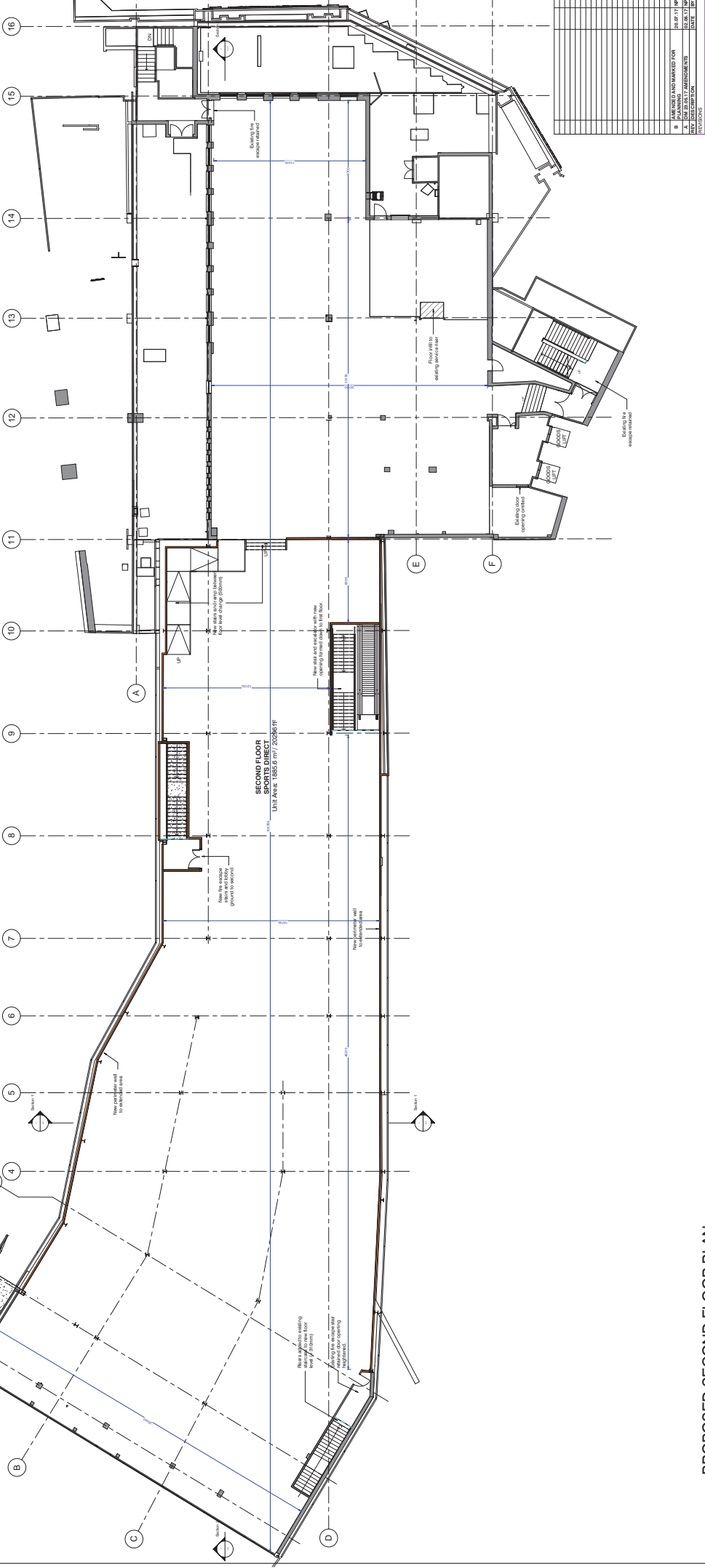

REV.		DESCRIPTION	DATE
1	A	AS PER CONSTRUCTION	11/01/2020
2	B	AMENDMENTS MARKED FOR	16/05/20
3	A	AS PER CONSTRUCTION	16/05/20
4	B	AS PER CONSTRUCTION	16/05/20
5	A	AS PER CONSTRUCTION	16/05/20
6	B	AS PER CONSTRUCTION	16/05/20
7	A	AS PER CONSTRUCTION	16/05/20
8	B	AS PER CONSTRUCTION	16/05/20
9	A	AS PER CONSTRUCTION	16/05/20
10	B	AS PER CONSTRUCTION	16/05/20
11	A	AS PER CONSTRUCTION	16/05/20
12	B	AS PER CONSTRUCTION	16/05/20
13	A	AS PER CONSTRUCTION	16/05/20
14	B	AS PER CONSTRUCTION	16/05/20
15	A	AS PER CONSTRUCTION	16/05/20
16	B	AS PER CONSTRUCTION	16/05/20

**CLIENT:** SPORTSDIRECT (COMMERCE) LTD  
**PROJECT:** 8937 HIGH STREET WOLVINGTON  
**DRAWING TITLE:** PROPOSED SECOND FLOOR PLAN  
**DRAWN BY:** JAVIER  
**CHECKED BY:** JAVIER  
**DATE:** 02/03/20  
**SCALE:** AS INDICATED  
**DRAWING NO:** CDS15110111B

**GROSS AREA**

AREA	SQM	SQ FT
BASEMENT	1772	18967 SF
EXISTING	1772	18967 SF
EXTENSION	154	1653 SF
<b>FIRST FLOOR</b>	<b>2056</b>	<b>22110 SF</b>
EXISTING	2056	22110 SF
EXTENSION	2056	22110 SF
<b>SECOND FLOOR</b>	<b>1856</b>	<b>20064 SF</b>
EXISTING	1856	20064 SF
EXTENSION	1856	20064 SF
<b>THIRD FLOOR</b>	<b>2056</b>	<b>22110 SF</b>
EXISTING	2056	22110 SF
EXTENSION	2056	22110 SF
<b>TOTAL</b>	<b>7240</b>	<b>77994 SF</b>

**PROPOSED SECOND FLOOR PLAN**  
 Scale 1 : 100

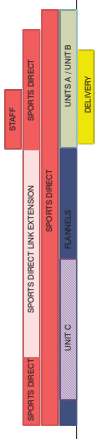

**SECTION KEY**

PROJECT: 8937 HIGH STREET WOLVINGTON  
 DRAWING TITLE: PROPOSED SECOND FLOOR PLAN  
 DRAWN BY: JAVIER  
 CHECKED BY: JAVIER  
 DATE: 02/03/20  
 SCALE: AS INDICATED  
 DRAWING NO: CDS15110111B

Project Management (Building Services)  
 Neill, Campbell & Co. (Group) Services  
 100000000 (Donnerstree) Mannagh Way, Ltd  
 100000000 (Donnerstree) Mannagh Way, Ltd  
 100000000 (Donnerstree) Mannagh Way, Ltd

**PLANNING - PROPOSED**

